

ASSEMBLY INSTRUCTIONS

KLEXKIT – Earlage Adapter, Claas Forage Harvester to Lexion Header

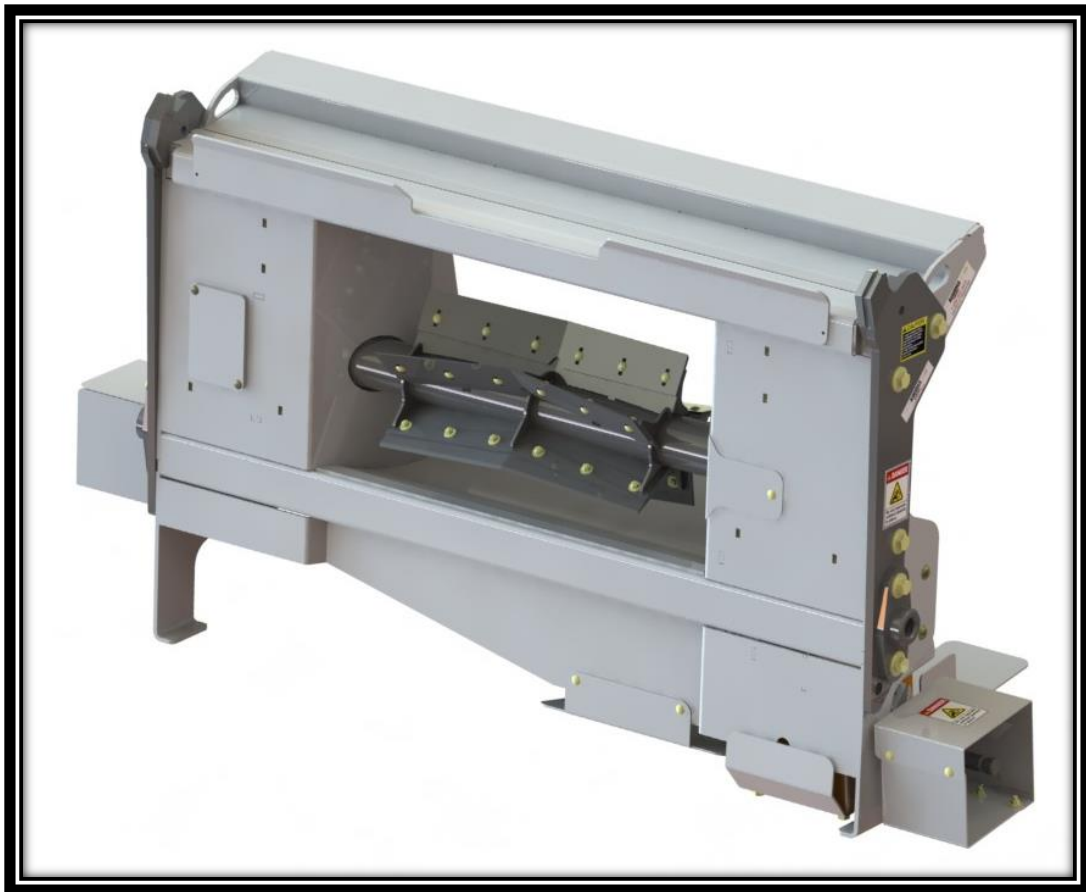

KOOIMA
COMPANY



1-800-522-8874

Thank you for your purchase of this Kooima Company earlage adapter.

KLEXKIT will install onto a Kooima Company Claas –to-John Deere header adapter (K00492 or K00494, Rev A or later). This combination will allow you to connect a Claas forage harvester to a Lexion corn header for the purpose of grinding earlage.

Follow the instructions below to prepare your adapter for harvest.

1. Remove several parts from your Claas adapter as shown below. They will not be used for this setup.

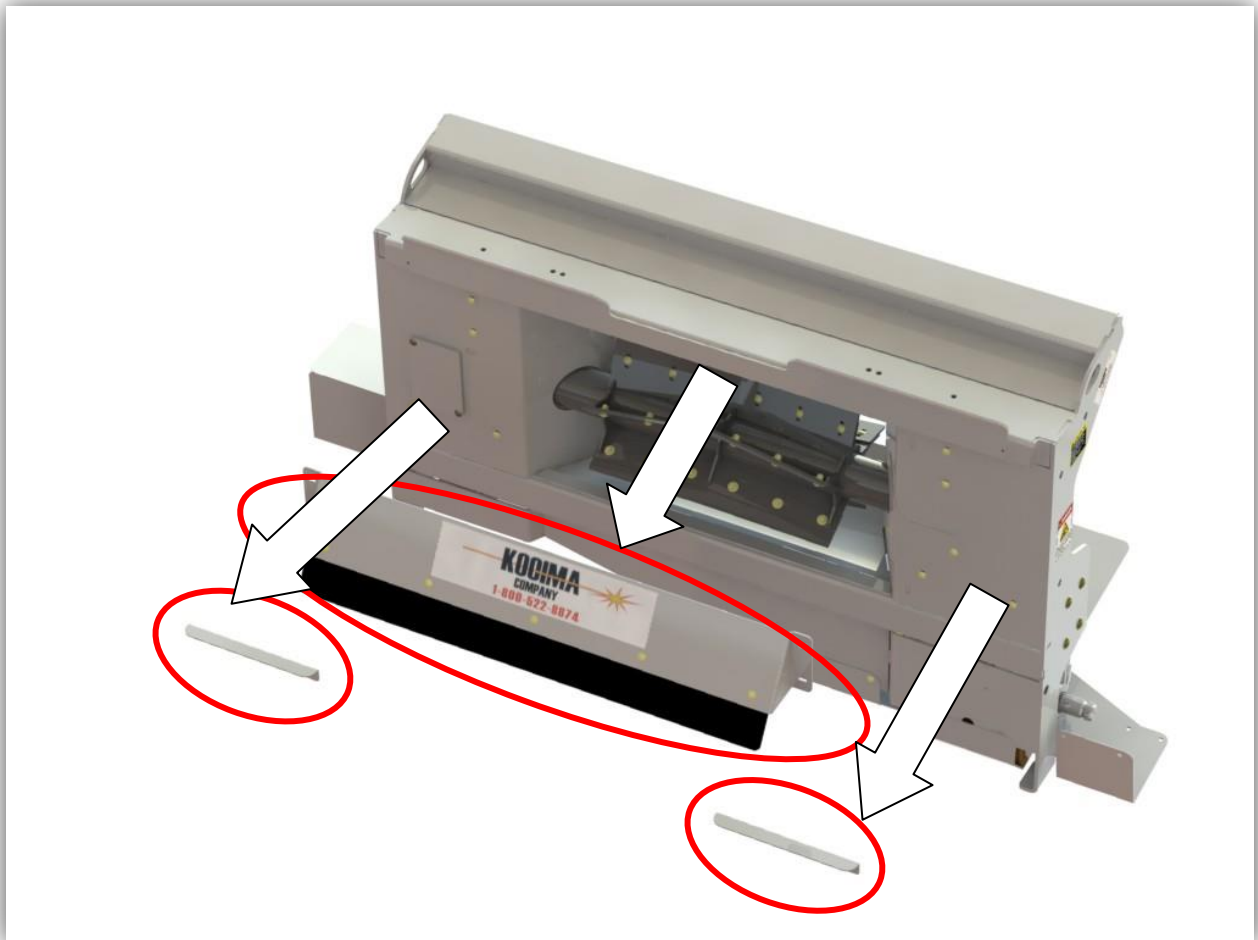

2. If needed, attach the splined adapter to the Claas adapter as shown below:

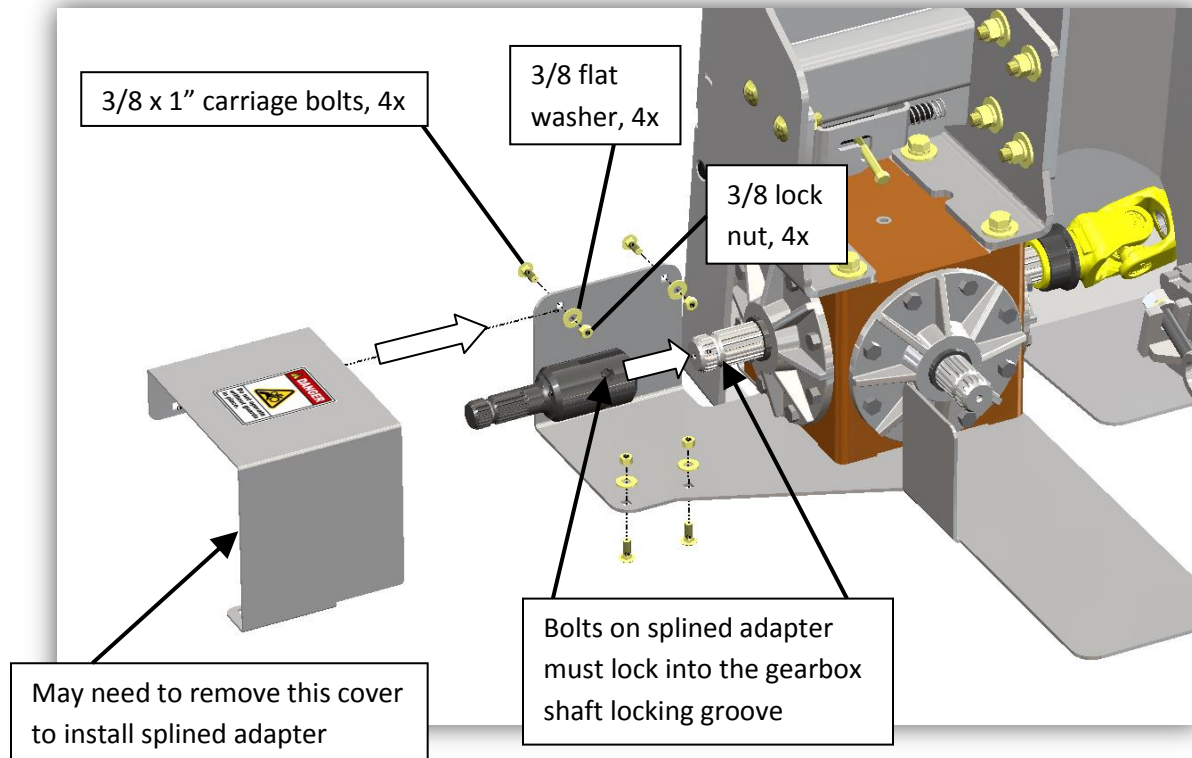

ASSEMBLED VIEW:

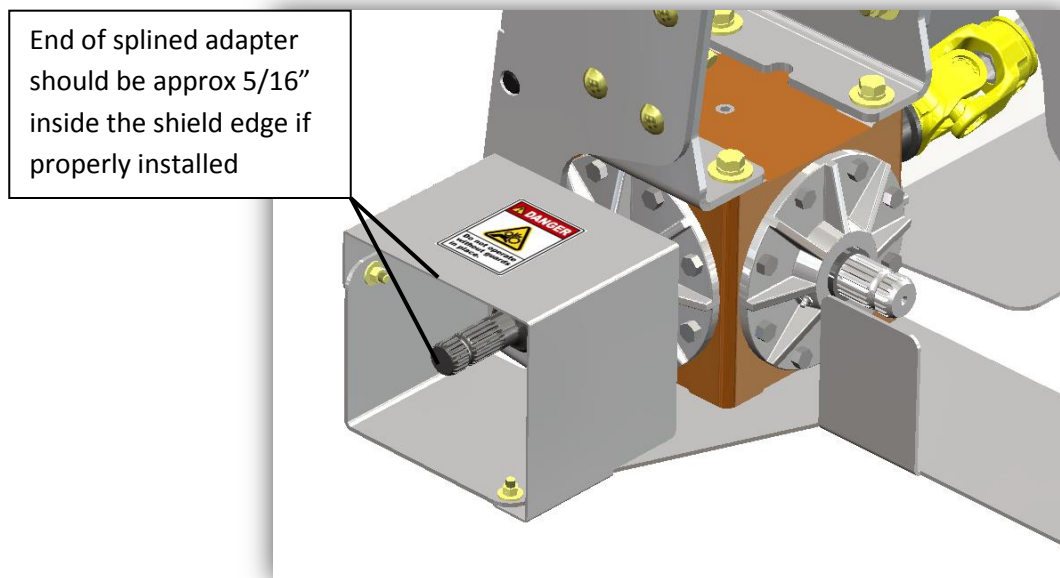

3. Bolt the Lexion weldments to the side of the Claas adapter as shown.
Repeat for the left side.

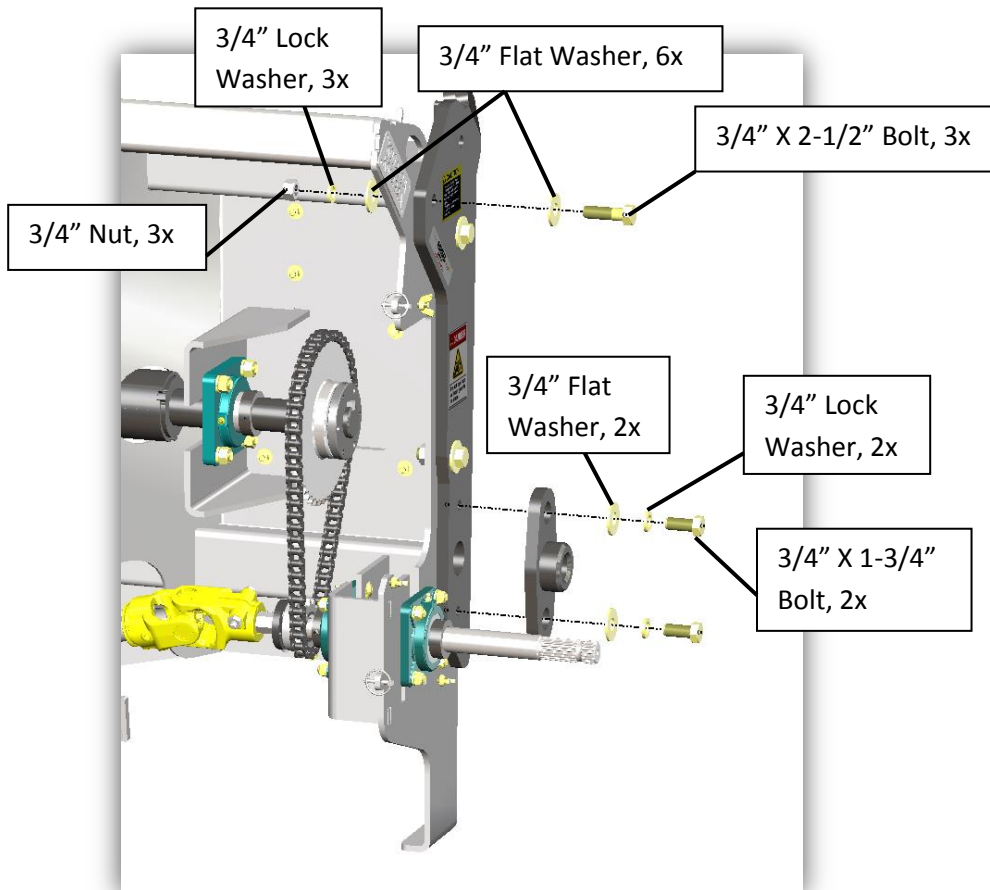

ASSEMBLED VIEW:

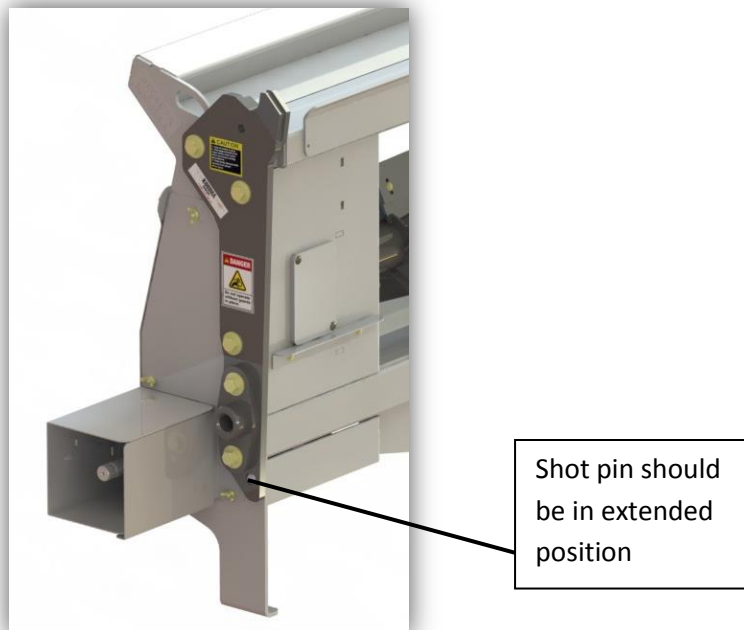

4. On your Lexion header, replace the two connecting pins with the shorter pins included with KLEXKIT. Reattach the connecting chain to the new pin.

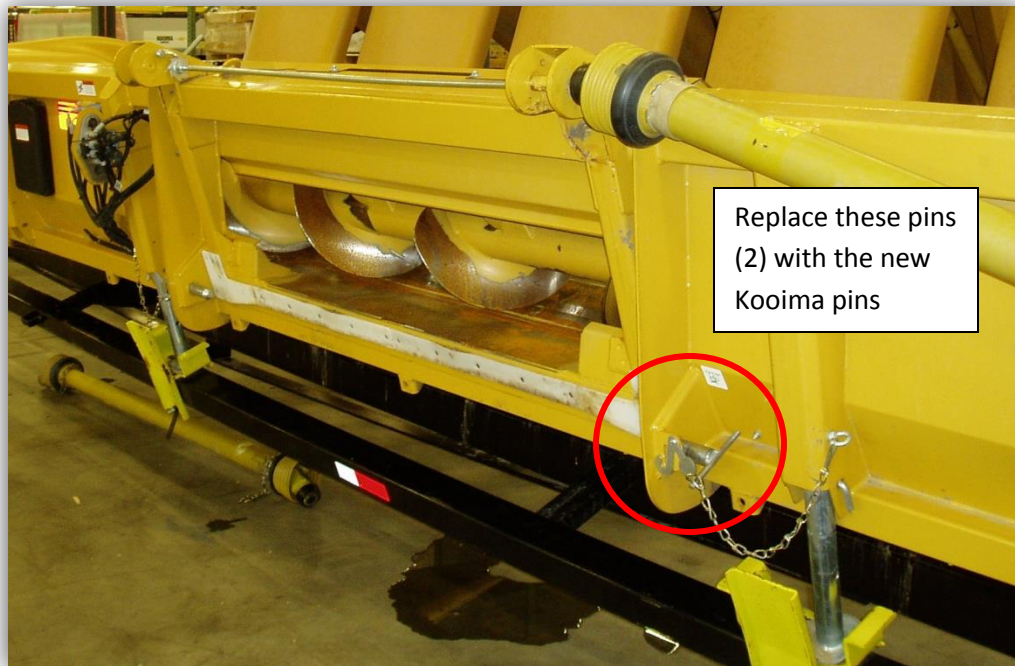

5. If you have a 12-row head, replace your left side PTO on the head (circled below) with the new one purchased from Kooima, part number KLEX12LEFT. This PTO shaft will connect from the head to the adapter gearbox.



6. Depending on your header configuration, the pieces shown below may also have to be removed from your header to prevent interference with the adapter.



7. Pick up corn header with adapter and cutter. If necessary, loosen bolts and adjust pin connector plates for better pin fit. Attach PTO shafts to adapter and forage harvester.



Your adapter is now ready for harvest!

